



FOLIO: 499/224374

SEARCH DATE	TIME	EDITION NO	DATE
-----	----	-----	----
6/5/2021	10:46 AM	-	-

VOL 10159 FOL 249 IS THE CURRENT CERTIFICATE OF TITLE

LAND

LOT 499 IN DEPOSITED PLAN 224374

AT GATESHEAD

LOCAL GOVERNMENT AREA LAKE MACQUARIE

PARISH OF KAHIBAH COUNTY OF NORTHUMBERLAND

TITLE DIAGRAM DP224374

FIRST SCHEDULE

NEW SOUTH WALES LAND AND HOUSING CORPORATION

SECOND SCHEDULE (2 NOTIFICATIONS)

- 1 LAND EXCLUDES MINERALS (S.141 PUBLIC WORKS ACT, 1912)
- 2 EXCEPTING LAND BELOW A DEPTH FROM THE SURFACE OF 15.24 METRES

NOTATIONS

UNREGISTERED DEALINGS: NIL

*** END OF SEARCH ***

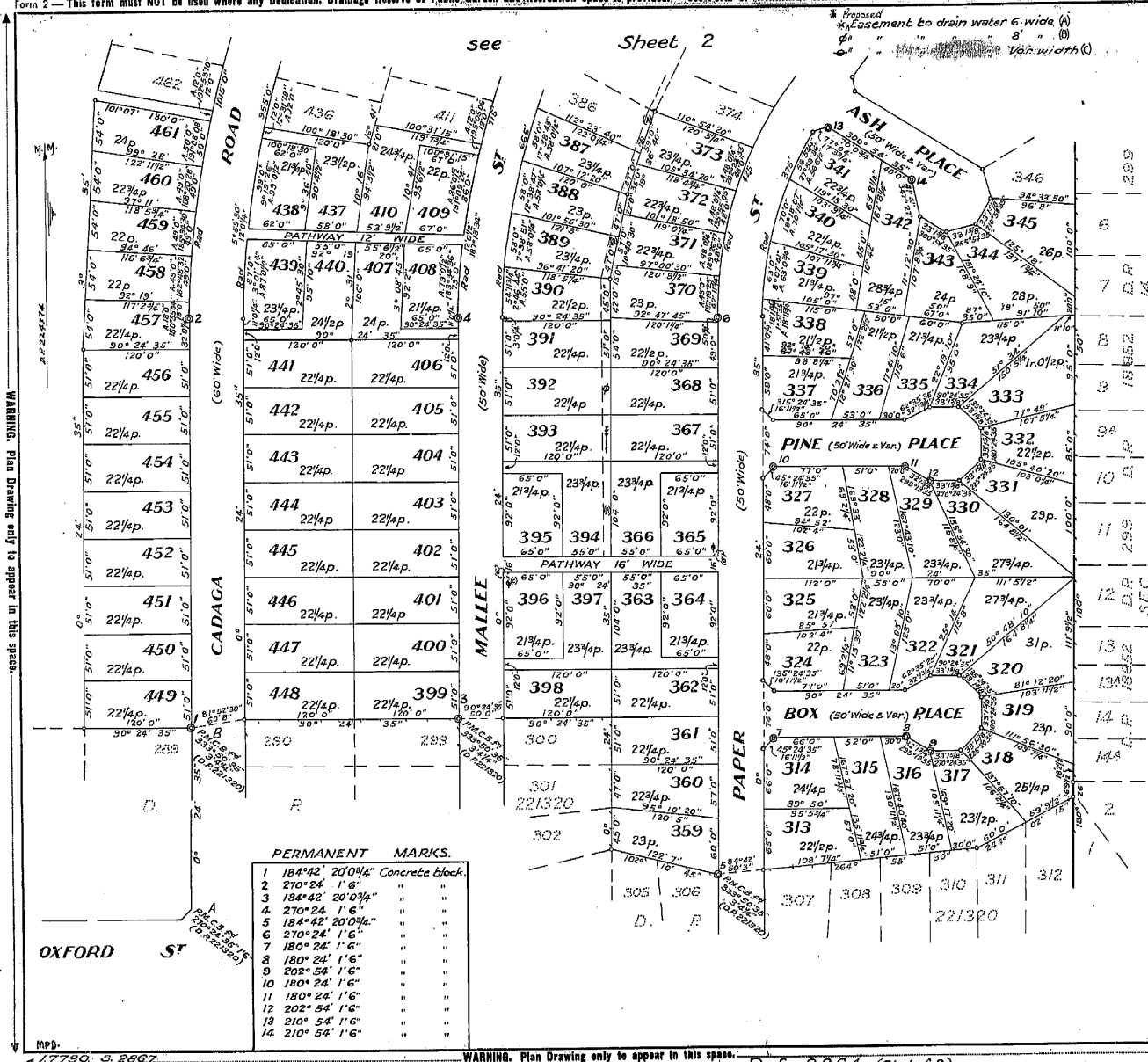

DP224374

Registered: 22/5/10/65

Owner: *Torrans*

Title System: *Subdivision*

Purpose: *Parish S.N.*

Ref. Map: *Parish S.N.*

Last Plan: *H708144, DP 217875*

PLAN OF subdivision of part of Lot 1 DP:217875 & part of land in C.T. Vol. 8422 Fol. 156.

Scale: 80 feet to an inch

Mem./Shire: *City of Lake Macquarie*

Locality: *Gateshead*

Parish: *Kahibah*

County: *Northumberland*

I, *David Banold Walpole*, of *PALMER BRUNN & WALPOLE Newcastle*, a surveyor registered under the Surveyors Act, 1920, as amended, hereby certify that the survey represented in this plan is accurate and has been made (1) by me (2) under my immediate supervision in accordance with the Survey Practice Regulations, 1933, and was completed on 1.12.1977.

Signature: *David Banold Walpole*

Surveyor registered under Surveyors Act, 1920, as amended. Datum: Line of Antiquity A-B

Statements of Proposed Easements. It is proposed to transfer to the Lake Macquarie Shire Council the easements to drain water shown hereon.

*Vide 1862M7500

Approved by Council. I hereby certify that the requirements of the Local Government Act, 1919 (other than the requirements for registration of plans), have been complied with by the applicant in relation to the proposed subdivision set out herein.

Subdivision No. Date:

Council Clerk:

Ref. 2864 (Sh. 1 of 2)

186452

186452

*Strike out either (1) or (2). If insert date of survey. 1.12.15-1838

I, Bruce Richard Davies, Registrar General for New South Wales, certify that this negative is a photograph made as a permanent record of a document in my custody this 24th day of May, 1977.

1

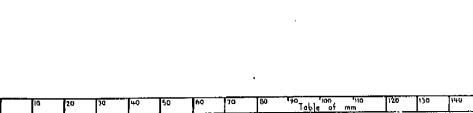

CONVERSION TABLE ADDED IN
REGISTRAR GENERAL'S DEPARTMENT

DP 224374 SH 1/2	FEET INCHES	METRES
- 6	- 6	0.152
1 6	1 6	0.407
3 0 1/4	3 0 1/4	0.921
3 4 1/4	3 4 1/4	1.022
5 0 1/4	5 0 1/4	1.330
6 -	6 -	1.829
8 -	8 -	2.438
8 0 3/8	8 0 3/8	2.601
11 0 1/4	11 0 1/4	3.309
11 10	11 10	3.607
11 11 1/2	11 11 1/2	3.645
12 -	12 -	3.658
12 0 1/4	12 0 1/4	3.654
12 0 1/2	12 0 1/2	3.657
15 -	15 -	4.572
16 -	16 -	4.877
16 9 1/2	16 9 1/2	5.118
16 11 1/2	16 11 1/2	5.169
17 3 3/4	17 3 3/4	5.277
18 -	18 -	5.486
18 2 1/2	18 2 1/2	5.590
18 11 3/4	18 11 3/4	5.785
20 -	20 -	6.096
20 0 3/4	20 0 3/4	6.115
21 -	21 -	6.401
22 -	22 -	6.705
30 -	30 -	9.144
30 11 1/2	30 11 1/2	9.406
32 0 1/4	32 0 1/4	9.760
32 1 3/4	32 1 3/4	9.798
33 1 5/8	33 1 5/8	10.100
35 -	35 -	10.666
40 -	40 -	12.192
41 0 1/4	41 0 1/4	12.303
41 4	41 4	12.598
42 -	42 -	12.802
42 11 3/4	42 11 3/4	13.100
43 -	43 -	13.106
45 -	45 -	13.716
47 -	47 -	14.326
48 -	48 -	14.630
48 0 1/4	48 0 1/4	14.637
49 -	49 -	14.935
50 -	50 -	15.240
50 3	50 3	15.315
51 -	51 -	15.945
52 -	52 -	15.890
53 -	53 -	16.194
53 9 1/2	53 9 1/2	16.396
54 -	54 -	16.499
54 11 3/4	54 11 3/4	16.788
55 -	55 -	16.764
55 6 1/2	55 6 1/2	16.929
56 5 3/4	56 5 3/4	17.215
56 6 1/2	56 6 1/2	17.284
57 -	57 -	17.374
58 -	58 -	17.678
58 0 1/4	58 0 1/4	17.685
59 -	59 -	17.993
59 9 1/2	59 9 1/2	18.225
60 -	60 -	18.288
60 0	60 0	18.491
62 -	62 -	18.898
63 -	63 -	19.202
63 0 3/4	63 0 3/4	19.221
65 -	65 -	19.812
66 -	66 -	20.117
67 -	67 -	20.422
69 2 1/4	69 2 1/4	21.088
69 0 1/4	69 0 1/4	21.241
70 -	70 -	21.356
70 0 3/4	70 0 3/4	21.385
70 1 1/4	70 1 1/4	21.368
70 2 1/2	70 2 1/2	21.400
74 -	74 -	22.595
77 -	77 -	23.470
78 11 3/4	78 11 3/4	24.073

CONVERSION TABLE ADDED IN
REGISTRAR GENERAL'S DEPARTMENT

DP 224374 SH 1/2 CONTD	FEET INCHES	METRES
79 -	79 -	24.079
79 0 1/2	79 0 1/2	24.092
85 -	85 -	25.908
86 -	86 -	26.213
86 0 1/2	86 0 1/2	26.226
87 -	87 -	26.518
87 0 1/4	87 0 1/4	26.524
90 -	90 -	27.432
90 4 1/2	90 4 1/2	27.546
91 10	91 10	27.991
92 -	92 -	28.042
92 2	92 2	28.092
94 1/2	94 1/2	28.740
95 -	95 -	28.956
95 5 3/4	95 5 3/4	29.102
95 5 1/2	95 5 1/2	29.121
96 8	96 8	29.464
98 0 1/4	98 0 1/4	30.080
99 -	99 -	30.175
99 0 1/2	99 0 1/2	30.188
100 -	100 -	30.480
102 4	102 4	31.191
102 9 1/4	102 9 1/4	31.629
105 11 1/2	105 11 1/2	31.687
104 -	104 -	31.699
105 -	105 -	32.004
106 -	106 -	32.309
106 2 1/4	106 2 1/4	32.366
107 5 1/4	107 5 1/4	32.747
107 8 3/4	107 8 3/4	32.836
107 11 3/4	107 11 3/4	32.912
108 0 1/4	108 0 1/4	32.925
108 4 3/4	108 4 3/4	33.039
108 7 1/4	108 7 1/4	33.103
108 9	108 9	33.147
109 7 1/4	109 7 1/4	33.407
109 11 1/4	109 11 1/4	33.509
111 5 1/2	111 5 1/2	33.873
111 9 1/2	111 9 1/2	34.074
112 -	112 -	34.158
115 -	115 -	35.052
115 6	115 6	35.204
115 8	115 8	35.258
115 8 1/4	115 8 1/4	35.262
116 6 3/4	116 6 3/4	35.528
117 2 5/4	117 2 5/4	35.751
118 4 5/4	118 4 5/4	36.087
118 5 1/4	118 5 1/4	36.100
118 5 3/4	118 5 3/4	36.112
119 0 1/4	119 0 1/4	36.278
119 7 5/4	119 7 5/4	36.458
120 -	120 -	36.576
120 1 1/4	120 1 1/4	36.608
120 3 1/2	120 3 1/2	36.665
120 5	120 5	36.703
120 5 1/4	120 5 1/4	36.709
121 8	121 8	36.957
122 0 1/4	122 0 1/4	37.192
122 2 1/4	122 2 1/4	37.243
122 2 1/2	122 2 1/2	37.249
122 7	122 7	37.363
122 11 1/2	122 11 1/2	37.478
123 -	123 -	37.490
130 -	130 -	39.624
130 11 1/2	130 11 1/2	39.916
135 11 5/4	135 11 5/4	41.446
137 1 3/4	137 1 3/4	41.802
150 5 1/4	150 5 1/4	45.853
162 8 1/4	162 8 1/4	49.537
164 8 1/4	164 8 1/4	50.197
164 8 1/2	164 8 1/2	50.203
375 -	375 -	114.300
425 -	425 -	129.540
665 -	665 -	202.632
715 -	715 -	217.932
955 -	955 -	291.084
1015 -	1015 -	309.372

CONVERSION TABLE ADDED IN
REGISTRAR GENERAL'S DEPARTMENT

DP 224374 SH 1/2 CONTD	AC RD P	SQ M
- 21 1/4	- 21 1/4	537.5
- 21 1/2	- 21 1/2	543.8
- 21 3/4	- 21 3/4	550.1
- 22	- 22	556.4
- 22 1/4	- 22 1/4	562.6
- 22 1/2	- 22 1/2	569.1
- 22 3/4	- 22 3/4	575.4
- 23	- 23	581.7
- 23 1/4	- 23 1/4	588.1
- 23 1/2	- 23 1/2	594.4
- 23 3/4	- 23 3/4	600.7
- 24	- 24	607
- 24 1/4	- 24 1/4	613.4
- 24 1/2	- 24 1/2	619.7
- 24 3/4	- 24 3/4	626
- 25 1/4	- 25 1/4	638.6
- 25	- 25	657.6
- 27 3/4	- 27 3/4	701.9
- 28	- 28	708.2
- 28 3/4	- 28 3/4	727.2
- 29	- 29	733.5
- 31	- 31	784.1
- 1 1/2	- 1 1/2	1024

I, Bruce Richard Davies, Registrar General for New South Wales, certify that this negative is a photograph made as a permanent record of a document in my custody this 24th day of May, 1977

Bruce Richard Davies

2

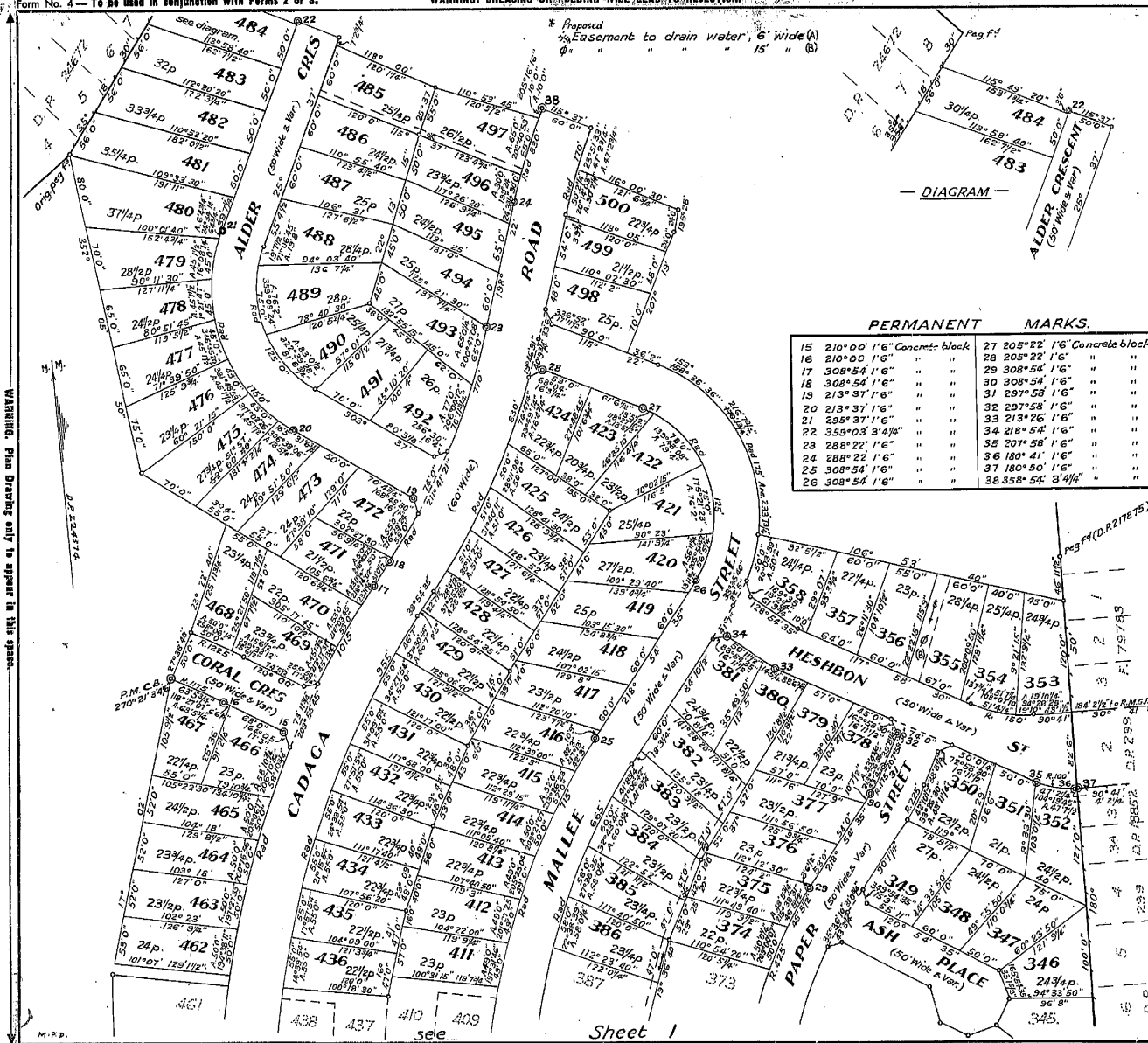

D P 224374

Registered.

This is Sheet of my plan in 2

Sheets dated

Dever
 Surveyor registered under Surveyors Act, 1929, as amended.

This is Sheet of the plan of 2

Sheets covered by my Certificate No.

. of

Council Clerk.

* Vide 1962 NT500

Scale: 80 feet to an inch

Ref. 2864 (Sh 2 of 2)

12425 to 54121 118455

CONVERSION TABLE ADDED IN
REGISTRAR GENERAL'S DEPARTMENT

DP 224374	SH	2/2	CONTO
FEET INCHES			METRES
1 6			0.457
3			0.914
3 4 1/4			1.022
3 6 1/2			1.080
3 9 3/4			1.162
4 2 1/4			1.276
5			1.524
6			1.829
6 4 3/4			1.949
6 6 1/4			1.988
7 2 3/4			2.203
7 6			2.286
8 5			2.565
9			2.743
10			3.048
10 7 1/2			3.239
10 9			3.277
13 5 1/2			4.102
13 7 3/4			4.159
13 11 1/2			4.255
14			4.267
14 5 1/4			4.401
15			4.572
15 6 1/2			4.737
15 9			4.801
16			4.877
16 3 1/4			4.959
16 4			4.978
16 11			5.156
16 11 1/2			5.169
17 2 3/4			5.251
17 5			5.259
17 11 1/2			5.474
18 2 1/4			5.544
18 3 1/4			5.569
18 5			5.613
18 5 1/4			5.620
19 7 1/2			5.982
19 8			5.994
19 10			6.045
19 10 1/4			6.052
22 7 1/2			6.896
23 11 1/4			7.296
24			7.315
24 3 3/4			7.410
28 4 1/2			8.649
30			9.144
31 0 1/2			9.462
31 0 3/4			9.468
31 6 3/4			9.520
32			9.754
32 5			9.881
32 7			9.931
33			10.058
33 1 5/8			10.100
35 4			10.160
35 4 3/4			10.179
35 6			10.211
36 2			11.024
38			11.582
38 5 3/4			11.754
38 8 1/4			11.792
39 7 1/4			12.071
40			12.192
40 9 3/4			12.440
41 7			12.675
41 8 3/4			12.719
42			12.802
42 8			12.878
42 7			12.979
42 10 1/2			13.068
43			13.106
43 1 1/2			13.145
43 3 1/4			13.189
43 11 1/4			13.392
45			13.716
45 1 1/2			13.754

CONVERSION TABLE ADDED IN
REGISTRAR GENERAL'S DEPARTMENT

DP 224374	SH	2/2	CONTO
FEET INCHES			METRES
45 1 3/4			13.760
46 7			14.199
46 11 1/2			14.313
47			14.326
47 2 1/4			14.383
47 2 3/4			14.395
47 7 1/2			14.516
48			14.530
48 5 1/2			14.770
48 5 3/4			14.776
49			14.935
50			15.240
50 0 1/4			15.246
50 2			15.291
50 2 1/4			15.297
50 11 1/2			15.532
51			15.545
51 4 1/4			15.603
51 7 1/4			15.729
52			15.880
53			16.134
54			16.459
55			16.764
55 4 1/2			16.878
55 11			17.043
56			17.069
56 5 1/4			17.202
56 11 1/4			17.355
57			17.374
58			17.678
58 0 1/4			17.685
58 10 3/4			17.951
59			17.983
60			18.288
60 0 1/4			18.294
61 6 1/2			18.708
61 9 3/4			18.840
62			18.898
63 5 3/4			19.348
64			19.507
65			19.812
65 0 1/4			19.818
67			20.422
67 7 1/2			20.612
68			20.726
70			21.356
70 4 3/4			21.437
70 8 1/4			21.546
70 9			21.565
71			21.641
73 11 3/4			22.549
74			22.555
74 5 1/2			22.695
75			22.860
76 2			23.215
76 4 1/4			23.273
76 4 3/4			23.285
76 11 3/4			23.465
77			23.470
78			23.774
78 8 1/2			23.990
79 4			24.181
79 10 3/4			24.392
80			24.384
80 3 1/4			24.457
81 6 3/4			24.800
82			25.146
83 0 1/2			25.311
84 10 1/2			25.870
90			27.432
90 1 1/4			27.464
91 2 1/4			27.794
92 5 1/2			28.181
93 3 3/4			28.442
96 6			29.413
96 8			29.464
96 9 1/4			29.496

CONVERSION TABLE ADDED IN
REGISTRAR GENERAL'S DEPARTMENT

DP 224374	SH	2/2	CONTO
FEET INCHES			METRES
100			30.480
100 4			30.582
101 6 3/4			30.956
103 0 1/4			31.401
104 2 1/2			31.763
104 10 1/2			31.966
105 5 3/4			32.175
105 9 1/2			32.245
105 10			32.258
110 0 3/4			33.547
110 8 1/2			33.744
110 10 1/2			33.795
112 2			34.188
112 5			34.265
115 0 1/2			35.053
115 9			35.281
116 4 1/4			35.465
116 9			35.484
119 3			36.347
119 4 1/4			36.379
119 5 1/2			36.411
119 7 1/2			36.462
119 7 3/4			36.468
119 9 1/4			36.506
119 9 1/2			36.613
119 11 1/4			36.657
120			36.576
120 1 1/4			36.608
120 5 1/4			36.709
120 5 1/2			36.716
120 5 3/4			36.722
120 6 3/4			36.747
120 8 1/4			36.786
120 9 1/2			36.817
121 3 1/2			36.970
121 5 3/4			36.976
121 4 1/2			36.995
121 5 1/4			37.040
121 6 3/4			37.052
121 8 1/4			37.090
121 9 1/4			37.116
121 11 1/2			37.173
122 0 1/4			37.192
122 3			37.262
123 4 1/2			37.605
123 4 3/4			37.611
123 7 1/2			37.681
124 2			37.846
125			38.100
125 9 3/4			38.348
125 11 3/4			38.396
125 9 1/4			38.540
126 9 3/4			38.652
127			38.710
127 5 1/2			38.875
127 9			38.938
127 11 1/4			38.995
128 1 1/4			39.046
129			39.319
129 1 1/2			39.357
129 6 1/2			39.484
129 8			39.522
129 8 1/2			39.555
130 5 1/2			39.840
131			39.929
131 2 1/4			39.986
132 9 1/4			40.469
134 8 3/4			41.065
134 10 3/4			41.115
135			41.148
136 7 1/4			41.637
137 7 1/4			41.942
139 4 3/4			42.488
141 9 1/4			43.212
145			44.196
150			45.720
152 4 3/4			46.450

CONVERSION TABLE ADDED IN
REGISTRAR GENERAL'S DEPARTMENT

DP 224374	SH	2/2	CONTO
FEET INCHES			METRES
153 1 3/4			46.679
162 7 1/2			49.568
172 3 1/4			52.508
175			53.340
182 0 1/2			55.486
184 2 1/2			56.147
191 11			58.496
216 7 3/4			66.034
225			68.580
233 7 3/4			71.215
425			129.540
665			202.692
715			217.932
770			234.696
830			252.984
955			291.084
1015			309.372
1175			358.140
1225			373.380
AC	RD	P	SQ M
-	20	3/4	524.8
-	21		531.1
-	21	1/2	543.8
-	21	3/4	550.1
-	22		556.4
-	22	1/4	562.8
-	22	1/2	569.1
-	22	3/4	575.4
-	23		581.7
-	23	1/4	588.1
-	23	1/2	594.4
-	23	3/4	600.7
-	24		607
-	24	1/4	613.4
-	24	1/2	619.7
-	24	3/4	626
-	25		632.3
-	25	1/4	638.6
-	26		657.6
-	26	1/2	670.3
-	27		682.9
-	27	1/2	695.6
-	27	3/4	701.9
-	28		708.2
-	28	1/4	714.5
-	28	1/2	720.8
-	29	1/4	739.8
-	30	1/4	765.1
-	32		809.4
-	33	3/4	853.6
-	35	1/4	891.6
-	37	1/4	942.2

I, Bruce Richard Davies, Registrar General for New South Wales, certify that this negative is a photograph made as a permanent record of a document in my custody this 24th day of May, 1977

4